

# Side channel pump SK 3301 - 3308-MK

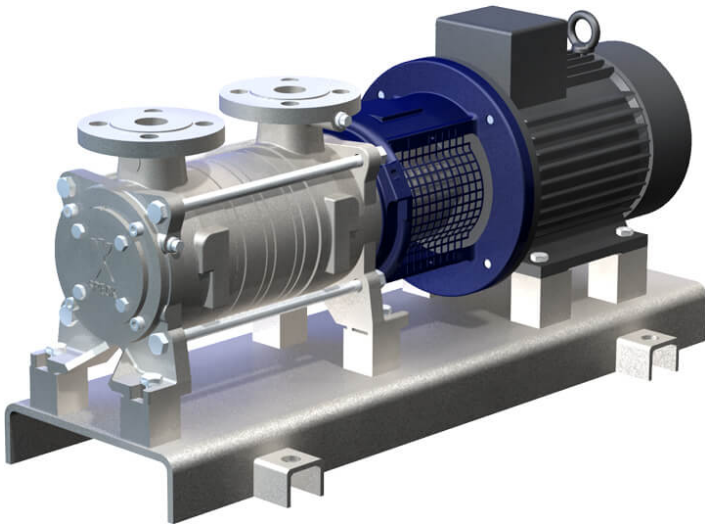

These self-priming, gas handling side channel pumps and side channel pumps with magnetic coupling handle liquids not containing solid matter and can be used for hot water applications or applications with great suction heights, for example boiler feed pumps or condenser pumps. Due to the magnetic coupling there is no shaft seal and the pumps can therefore also be used for difficult media.

## Details

Flow rate  $Q$  in  $\text{m}^3/\text{h}$ : 7,5

Motor performance in kW (P2): 0,75 - 11

Total head  $H$  in m WS: